

POLYJOHN® III ASSEMBLY INSTRUCTIONS

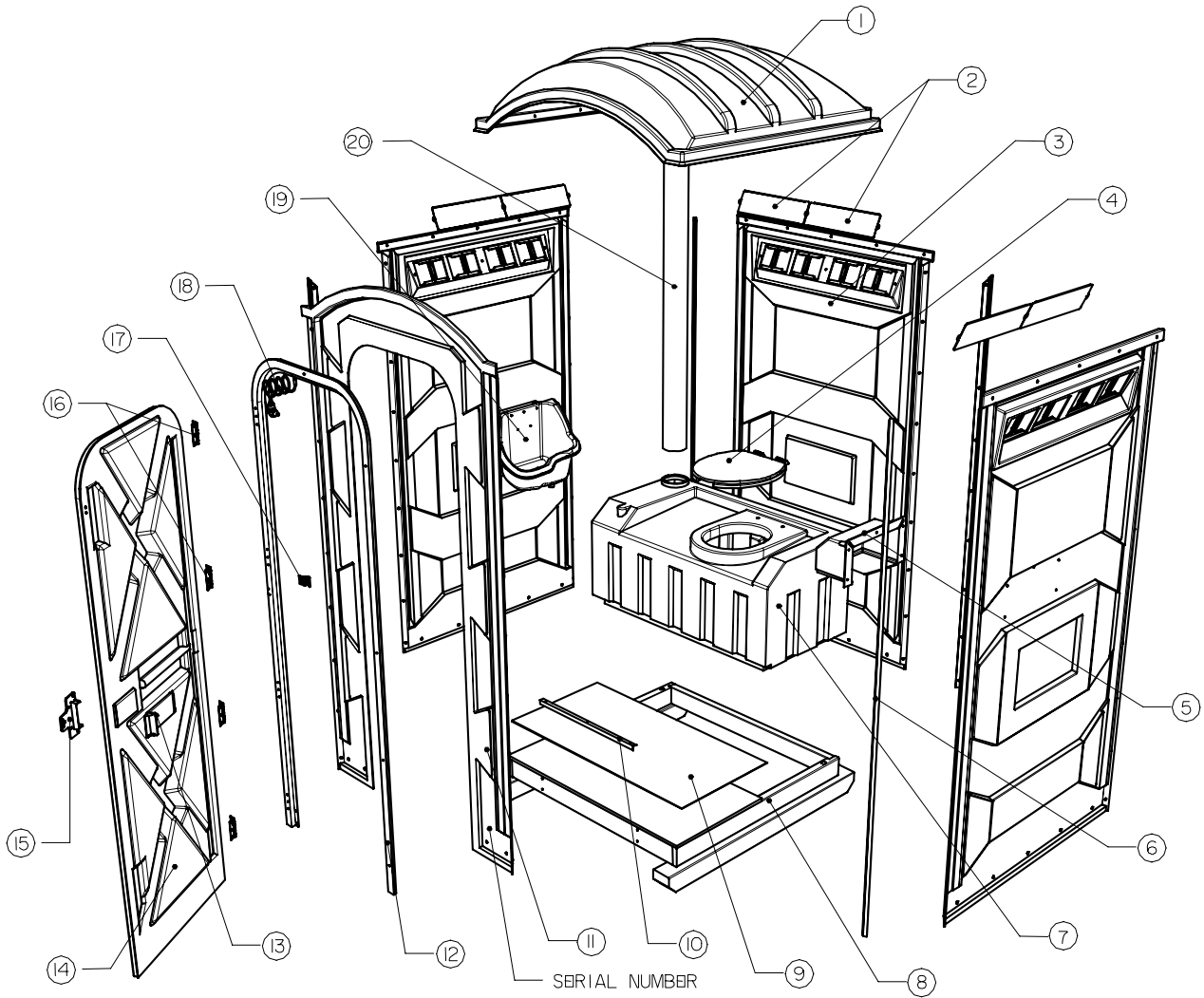

POLYJOHN® III BILL-OF-MATERIALS

ITEM	PART #	DESCRIPTION	REQ
1	PJ03-0007	Roof	1
1a *	PC-000100	Rivet, large flange, short - roof to wall panels	20
1b *	PC-000106	Washer, 3/16, back-up - roof to wall panels	20
2	PC-000570	Screen, Fly	6
2a *	PC-000100	Rivet, large flange, short - fly screens to wall panels	9
2b *	PC-000106	Washer, 3/16, back-up - screens to wall panels	9
3	PJ03-0002	Panel, side wall	3
3a *	PC-000192	SEMS, screw, lag w/washer, 1/4 x 1 1/4 - wall panels to skid base	15
4	PC-000204	Seat, toilet w/lid, black	1
5	PC-000480	Dispenser, toilet paper	1
5a *	PC-000100	Rivet, large flange, short - dispenser to wall panel	5
5b *	PC-000106	Washer, 3/16, back-up - dispenser to wall panel	5
5c *	PC-000760	Rod, toilet paper roll holder	1
5d *	PC-000205M	Lock, Master, keyed alike	1
6	PJ03-0011	Corner moulding	4
6a *	PC-000100	Rivet, large flange, short - corners to wall panels	36
6b *	PC-000106	Washer, back-up, 3/16 - corners to wall panels	36
7	PJ03-0008	Tank, waste holding	1
7a *	PC-000101	Rivet, large flange, long - tank to wall panels	8
7b *	PC-000106	Washer, back-up, 3/16 - tank to wall panels	8
8	PJ03-0001	Skid, treated lumber	1
8a *	PJ03-0039	Kick plate	1
9	PJ03-0010	Cover, floor	1
10	PJ03-0030	Threshold	1
10a *	PC-000138	Nail, roofing - threshold to skid	3
	PJ03-0003	Front assembly w/door, jamb, hinges, closure & door pull	1
11	PJ03-0004	Panel, front wall	1
11a *	PC-000192	SEMS, screw, lag w/ washer - front panel to skid base	4
12	PJ03-0006	Jamb, door	1
12a *	PC-000104	Rivet, small flange, long - jamb to front panel	5
12b *	PC-000122	Bolt, truss head, 1/4 x 2 1/4 - jamb to skid base	4
12c *	PC-000123	Washer, 1/4 x 5/8 - jamb to skid base	4
12d *	PC-000140	Nut, lock, 1/4-20 Nylon - jamb to skid base	4
13	PJ03-0038	Latch, slide, 3", w/decal	1
13a *	PC-000781	Decal, occupancy, in-use/open	1
14	PJ03-0005	Door, w/hinges & door spring closure	1
14a *	PC-000180	Closure, door comp. spring assembly	1
15	PJ03-0043	Door pull	1
15a *	PC-000102	Rivet, small flange, short - door pull to inner door pillar	2
15b *	PC-000105	Rivet, star, small flange, long - door pull to door	2
16	PC-000170	Hinge, 3"	4
16a *	PC-000102	Rivet, small flange, short - hinge to door	12
16b *	PC-000104	Rivet, small flange, long - Hinge to doorjamb	12
17	PC-000181	Clip, cable	1
17a *	PC-000104	Rivet, small flange, long - clip to doorjamb	2
18	PC-000200	Cable, coiled, door check	1
18a *	PC-000102	Rivet, small flange, short - cable check clip to door	2
18b *	PC-000104	Rivet, small flange, long - loop of cable to jamb	1
18c *	PC-000123	Washer, 1/4 x 5/8 - loop of cable to jamb	1
18d *	PC-000106	Washer, back-up, 3/16 - loop of cable to jamb	1
19	PJ03-0009	Urinal	1
19a *	PC-000100	Rivet, large flange, short - urinal to side panel	5
19b *	PC-000106	Washer, back-up, 3/16 - urinal to side panel	5
20	PC-000531	Stack, vent	1
20a *	PC-000101	Rivet, large flange, long - vent stack to waste tank	1
20b *	PC-000106	Washer, back-up, 3/16 - vent stack to waste tank	1

Item numbers indicated with an *are not shown. However, they are used with the number before it without an alphabetical suffix.

OPTIONAL PLASTIC SKID WITH RECYCLED PLASTIC 5/8" THICK FLOOR

8 *	PJ03-0001AP	Floor, recycled plastic	1
8a *	PC-000158	Screw - floor to skid base	6
9 *	PJ03-0001R	Skid, base, plastic	1