



PJF3-0201

FT02/PSN1 Conversion

PJN3 Recirculating to Fresh Flush

Technical Information

SPECIFICATIONS

DIMENSION	IMPERIAL	METRIC
Height	43.5 in	110 cm
Width	20 in	50 cm
Depth	9 in	22 cm
Tank Capacity	15 gal	56.8 ltr
Pump Capacity (per stroke)	2 fl. oz	59.14 ml
Number of Single Dispenses	960	960
Weight Empty	20.5 lb	9.3 kg
Weight Full	145 lb	65.8 kg

General Product Overview

The *FT02/PSN1 Conversion* is designed specifically for the *PJN3* model portable restroom. Easily converts an existing recirculating system to a fresh flushing system. Complies with mandated fresh flushing regulations.

SPECIFICATIONS

Dimension	Imperial	Metric
Height	24.5 in	62 cm
Length	41 in	104 cm
Depth	24 in	61 cm
Weight - Empty	37 lb	16.65 kg
Tank Capacity	35 gal	132 ltr
Pump Capacity (per stroke)	8 oz	236 ml

Tools Required

- Rivet Gun
- Drill with 13/64" bit
- Screw driver
- 1-1/4" hole saw
- 2" hole saw
- Tape measure

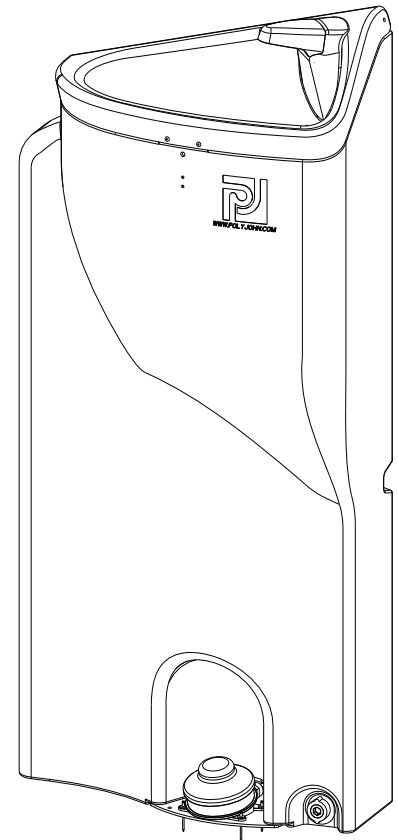
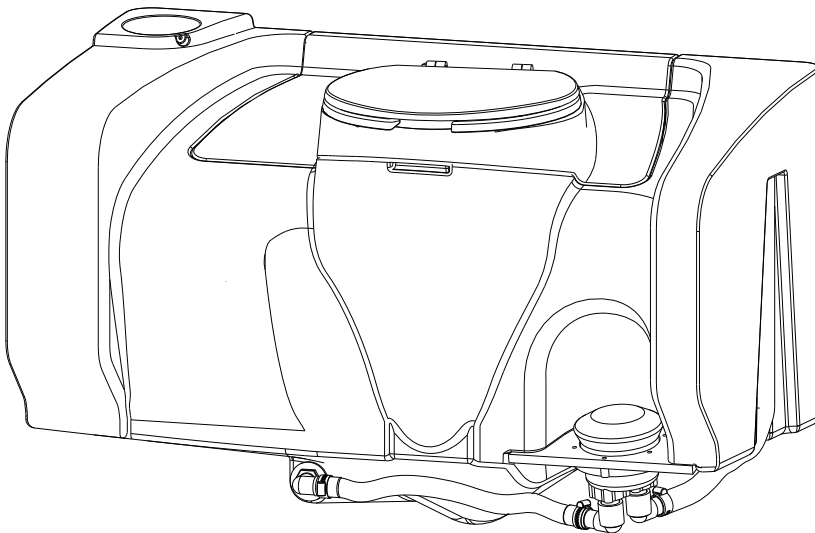

We recommend reading through the entire booklet prior to proceeding with the installation, service or maintenance. All references to the right and left throughout this guide are as viewed from the front of the restroom. Assembly for the FT02/PSN1 Conversion will require two people.

POLYJOHN USA

PolyJohn Enterprises Corp
2500 Gaspar Ave.
Whiting, IN 46394
Phone: 800-292-1305
Fax: 219-659-0625
www.polyjohn.com
info@polyjohn.com

POLYJOHN WORLDWIDE

PolyJohn (UK) Ltd.
Equinox 1 Audby Lane
Wetherby, England LS22 7RD
Phone: 44 (0) 1937-583333
Fax: 44 (0) 1937-583322
sales@polyjohn.co.uk

POLYJOHN CANADA

PolyJohn Canada
P.O. Box 2300
199 Forest Plain Rd.
Orillia, Ontario LV3 6S2
Phone: 800-465-9590
Fax: 705-325-8250
info@polyjohncanada.ca

Full Size Scale Fasteners

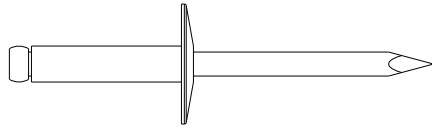

(2) PC-000103 Rivet

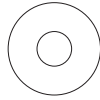

(2) PC-000106 Washer

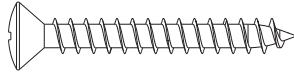

(1) PC-000158 Self-Tapping Screw

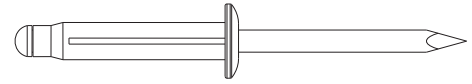

(2) PC-000105 Rivet

Converting An Existing PJN3 Recirculating Waste Tank and Sink to Fresh Flush

IMPORTANT: PUMP OUT THE TANK AND THOROUGHLY CLEAN THE INTERIOR PRIOR TO WASTE TANK CONVERSION.

Refer to Illustrations and Parts Bag.

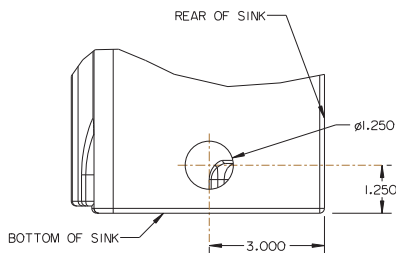
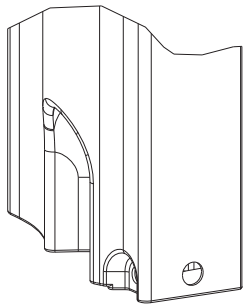
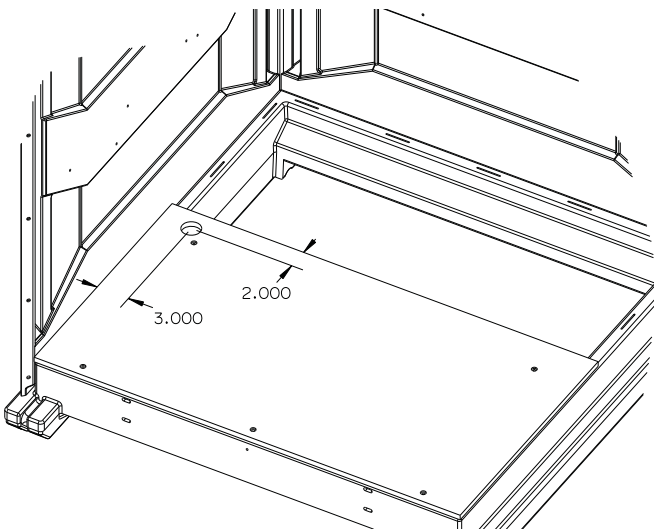

Conversion Instructions

- Pop out the filters located in the floor of the tank with a screwdriver and discard.
- Pour a cleaning solution containing bleach and water into the tank and pump through several times.
- Empty out and detach the existing sink and set aside.
- Drill a hole in the floor base with the center of a 2" hole saw in the location approximately 3" away from the left side edge and 2" in from the inside edge of the floor.
- Cut the existing Discharge Hose (*connected to the Flush Bowl*) approximately 5" away from the "Nozzle".
- Attach a PC-000901 Straight Hose Adapter to each end of a PC-000908 Check Valve. Connect to both cut hose ends with the arrow on the Check Valve pointing towards the bowl. **NOTE: Make sure to place a PC-000352 Hose Clamp on each hose end and tighten.**
- Drill a hole in the sink with the center of a 1-1/4" hole saw in the location approximately 3" away from the back edge of the sink and 1-1/4" from the bottom edge of the sink.
- Insert a PC-000417 Uniseal into the hole just drilled in the sink. Insert into the Uniseal a Filter-Elbow Assembly (*PC-000305 Filter/PC-100316 Elbow/(2) PC-000237 O-Rings*).
- Place the sink into the unit.
- Attach a 36" Hose to the elbow on the sink and feed down through the hole in the floor base. **NOTE: Make sure to place a PC-000352 Hose Clamp on the hose end and tighten.**

Conversion Instructions (continued)

- *Re-Mount the PSN1-1000 Sink:* Make sure the sink is pressed flat against the sidewall. From the exterior rivet into the existing holes (2) PC-000103 Rivets with (2) PC-000106 Back-up Washers on the inside of the sink.
- *Attach the sink to the base skid:* Drive (1) PC-000158 Self-tapping screw in the predrilled hole in the sink pump mounting plate.
- Tilt the unit on its back.
- Remove and discard the existing PC-100309 Elbow and 16.5" hose that is connected to the "In" port of the pump. Plug the hole from the elbow with a PC-000554 - 1" Gray Plug with Tether and a PC-000345 O-Ring.
- Attach the 36" hose from the sink to the "In" port of the pump. **NOTE: Make sure to place a PC-000352 Hose Clamp on the hose end and tighten.**
- Secure the hose to the crossbar of the base with a PC-000350 - Clamp and rivet into place with (2) PC-000105 Rivets.

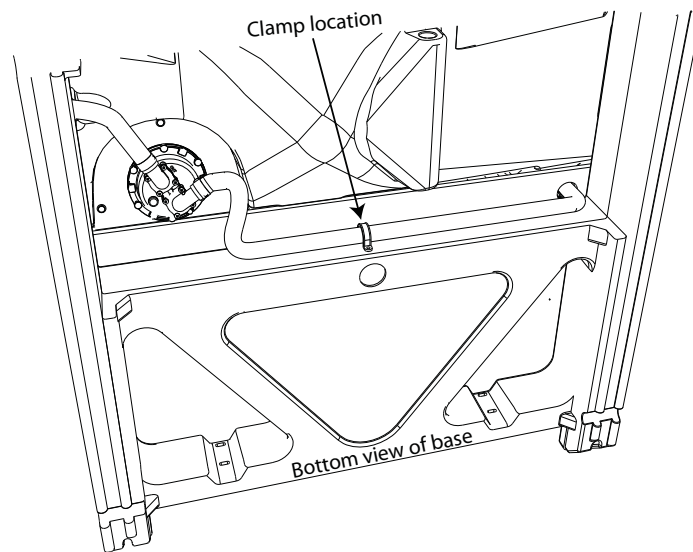

- Set the unit upright.
- Perform a system check by adding a few gallons of water to the sink. Depress the pump a few times to "prime" it. The pump has a built in check valve that will hold the prime between uses.

CLEANING AND MAINTENANCE

Use a mild soap to clean all surfaces and component parts.

Minor scratches and abrasions can be lightly sanded or scrubbed with a mild abrasive cleaner (such as "Soft Scrub") that contains calcium carbonate, hypochlorate bleach and detergents. Be sure to follow the cleaning product directions since these ingredients may cause hazardous gases when mixed with other chemicals. Rinse the cleaned area and buff with a conventional wax.

Some light scratches may also be hidden by using an industrial hot air gun.

Add a "Fresh Sink Tablet" (*chlorinated tablet*) each time the sink is filled with water to keep the water fresh.

For a source of cleaning, deodorizing and paper products contact:

RID IT
2500 GASPAR AVE.
WHITING, IN 46394-2175
800-292-1305 EXTENSION 514
www.rid-it.com

THANK YOU FOR PURCHASING POLYJOHN PRODUCTS!

Look for us on the Web @ www.PolyJohn.com